



TAURUS XP MIG TORCH CONSUMABLES

Description

TAURUS XP MIG TORCH CONSUMABLES

TAURUS XP CONTACT TIPS

Taurus XP contact tips are manufactured from a hard and high-conductivity copper alloy which means less frequent replacements which result in savings on welders' downtimes and on consumables. Contact tips guide the welding wire and transfer the current from the conductor tube (swan neck) through the MIG wire to the work piece. In order to ensure the best welding performance, it is important to select the correct size welding tip. An incorrect tip size can lead to problems such as micro-arcing, overheating, friction and wire jamming all resulting in wire burn-back.

THREAD SIZE

HOLE DIAMETER

M8 : XP TORCH (200A – 300A)



- 0.8mm
- 0.9mm
- 1.0mm
- 1.2mm

M10 : XP TORCH (300A – 450A)



- 0.9mm
- 1.0mm
- 1.2mm
- 1.4mm
- 1.6mm

TAURUS TIP ADAPTOR/HEAD ASSEMBLY

The Taurus XP head assembly holds the contact tip and the gas diffuser in place.

XP200A – XP300A XP TORCH : M8 OR
M10

XP350A – XP450A XP TORCH : M10



TAURUS XP GAS DIFFUSER

The Taurus XP gas diffuser provides gas flow to the weld pool.

XP200A – XP300A XP TORCH : M8 –
CERAMIC



XP350A – XP450A XP TORCH : M10 –
CERAMIC



XP200A – XP300A XP TORCH : M8

XP350A – XP450A XP TORCH : M10



TAURUS XP HEAT SHIELD

The Taurus XP heat shield reduces the heat-flow from the nozzle reaching the conductor tube (swan neck).

XP200A – XP300A XP TORCH : M8 –
ALUMINIUM



XP200A – XP300A XP TORCH : M10 –
ALUMINIUM

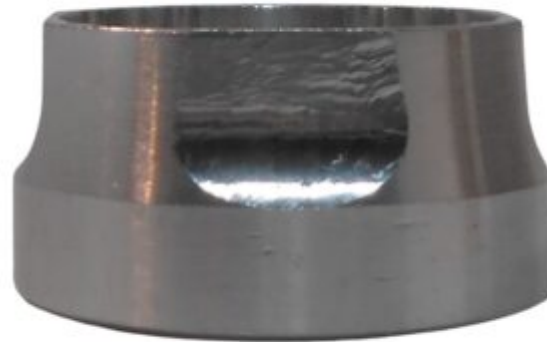

XP200A – XP300A XP TORCH : M8 –
BLACK

XP200A – XP300A XP TORCH : M10 –
BLACK



TAURUS XP NOZZLES

Taurus XP MIG nozzles are precision engineered and have a thicker wall thickness resulting in superior performance and longevity. The nozzle, also known as a shroud, is used to keep the gas at the weld puddle. When the nozzle spatter builds up or if the nozzle becomes damaged due to miss use, wear and tear or overheating, it can cause the shielding process to be uncontrolled which may result in poor welding, lack of penetration and increased spatter. Build-up of spatter between the contact tip and the nozzle can result in shorting. The nozzle cleaning process can be facilitated by using silicon anti spatter spray which makes removal of the spatter easier. The nozzle can also

be removed from the MIG torch and a wire brush used to clean off the spatter build-up.

200A – 300A XP TORCH – CONICAL
(16MM)



200A – 300A XP TORCH – TAPERED
(13MM)



300A – 450A XP TORCH – CONICAL
(16MM)



300A – 450A XP TORCH – LONG
CONICAL (16MM)



TAURUS XP LINERS

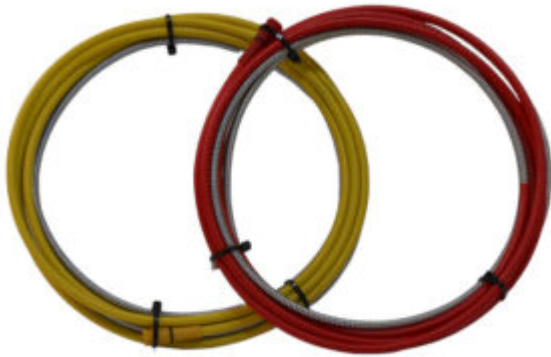

The Taurus XP liner is the guide for the welding wire through the MIG torch to the contact tip. The correct liner is required to ensure smooth, consistent wire feed and high-quality welding. Several criteria such as wire thickness, torch length and type of wire material should be considered when selecting the correct liner. When the internal diameter of the liner is too small for the wire being used, wire feed will be affected. When the internal diameter of the liner is too large for the wire being used, the wire could fold back. When thinner wire is used, erratic feeding or even blockages can occur. Liners need to be cut to the correct length when installed. Wire feeding problems can result from liners cut too short. It should fit tightly against the contact tip. The correct liner should be selected for the type of welding wire used – steel liners for mild steel wires. Aluminium alloy wires require smoother teflon liners and for stainless steel wires harder carbon-teflon liners are required. Regular cleaning of liners is necessary to prevent clogging. Due to friction, liners do wear out and should be replaced periodically.

XP LINER CHART

PRODUCT CODE	LINER TYPE	LENGTH	WIRE SIZE	WIRE TYPE	200A	300A	350A	400A
XP2024-09.40	STEEL – PVC COATED	3m	1.0 – 1.2	STEEL WIRES	?	?		
XP2024-12.30	STEEL – PVC COATED	3m	1.0 – 1.2	STEEL WIRES	?	?		
XP2024-12.40	STEEL – PVC COATED	4m	1.0 – 1.2	STEEL WIRES	?	?		
XP3524-12-40	STEEL – PVC COATED	4m	1.0 – 1.2	STEEL WIRES			?	?
XP3524-12-50	STEEL – PVC COATED	5m	1.0 – 1.2	STEEL WIRES			?	?
XP3524-16-40	STEEL – PVC COATED	4m	1.2 – 1.6	STEEL WIRES			?	?
XP3524-16-50	STEEL – PVC COATED	5m	1.2 – 1.6	STEEL WIRES			?	?

Product Category

1. Mig Torches and Accessories
2. Consumables
3. XP Torches

Date Created



12 Nov 2025